



## Diabetes care





## Vitrex® Alcohol Swabs

Vitrex Alcohol swabs are an easy and convenient way to cleanse the skin and help fight bacteria at the site of application. Use as an antiseptic skin cleanser before injections and blood sampling.

Each Alcohol Swab is individually sealed and disposable for convenience and safety.

### Technical Specifications

Description	Size	Content	Pcs./Box	Article No.
Alcohol Swabs	30 x 60 mm	70% Isopropyl Alcohol	100	520213
Alcohol Swabs	30 x 60 mm	82% Ethanol	100	521213
Alcohol Swabs	30 x 60 mm	82% Ethanol + 0.5% Chlorhexidine	100	522213

**Shelf life 5 years**



**Packaging:**  
 Primary packaging: 100 pcs.  
 Transit packaging: 10,000 pcs.  
 Pallet: 400,000 pcs.

## Vitrex® Safety Containers

Vitrex Safety Containers are designed for hospitals and healthcare institutions for clinical disposal of lancets, needles, scalpels, syringes and other types of sharps.

Each type of lid is specially designed to help the user dispose needles, syringes, etc. Lid with reversible closure can be safely fixed.



### Technical Specifications

Description	Size	Content	Article No.
Safety container	4.7 cm x 12.9 cm	0.2 l.	193800
Safety container	9 cm x 10.8 cm	0.5 l.	194000
Safety container	13.7 cm x 12.5 cm	1.5 l.	194200
Safety container	13.7 cm x 18 cm	2 l.	194300
Safety container	21.1 cm x 19.5 cm	5 l.	194700

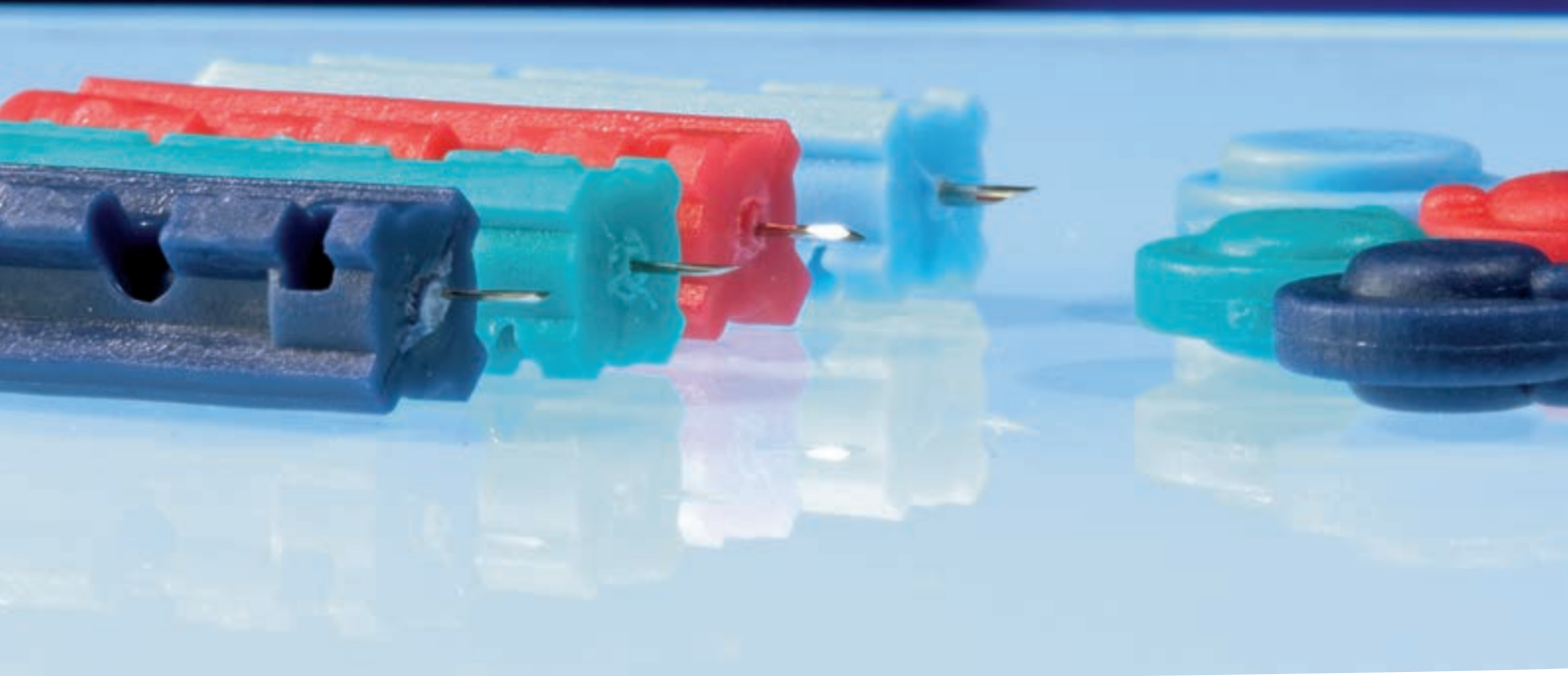

## Vitrex® Soft Blood Glucose Lancets

### GOOD BLOOD FLOW

Triple ground needle point.

### VERSATILE

Fit most commonly used lancing devices including the Vitrex Compact Eject lancing device.

### STERILE

Sterilised by gamma irradiation at minimum 25kGy.





### CONVENIENT

Boxes have dispensing feature.

### New siliconized needle



For less pain and smoother penetration.

### Technical Specifications

Colour Code		Specification	Pcs./Box	Article No.
Light blue		23G (0.65 mm)	200	351213
Red		28G (0.38 mm)	200	352213
Green		30G (0.31 mm)	200	354213
Dark blue		32G (0.26 mm)	200	357213

**Shelf life 5 years**

### Technical Specifications Siliconized Needles

Colour Code		Specification	Pcs./Box	Article No.
Red		28G (0.38 mm)	200	352413
Green		30G (0.31mm)	200	354413

**Shelf life 5 years**



Transit packaging

Pallet

**Packaging:**  
 Primary packaging: 200 pcs.  
 Secondary packaging: 2,000 pcs.  
 Transit packaging: 20,000 pcs.  
 Pallet: 480,000 pcs.



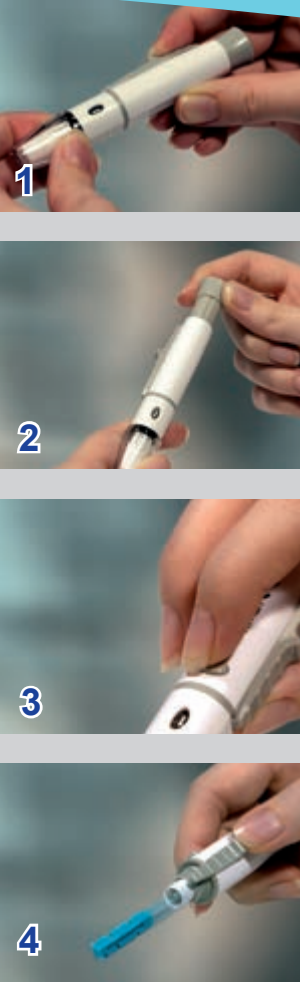

## Recommended use

### 1. Variable penetration

Dial the appropriate depth on the device between 1 (min.) and 6 (max.).

### 2. Simple and quick activation and reactivation

Pull back the grey slider to activate the mechanism.

### 3. Instant operation

Depress the grey button to operate the device.

### 4. Lancet removal

Simple and reliable lancet ejection.

## Vitrex® Compact Eject

Vitrex Compact Eject is a lancing device with a push button ejection. The device is clear adjustable with clear fixed end caps designed for Alternate Site Testing (AST).

### VERSATILE

Suitable for use with Vitrex Soft Lancets and other most commonly used lancet brands.

### VARIABLE PENETRATION

Six depth settings from 1 to 6.

### CONVENIENT

Simple and quick activation, reactivation and non-touch lancet removal.

## Technical Specifications

Product	Description	Packaging	Article No.
Vitrex Compact Eject	6-step adjustable depth	Clear plastic sleeve only	369400



4.



- Big Screen
- One Code (No Coding requested)
- Small Carrier package

## Blood Glucose Monitor System

### Easy to Read, Use and Carry

The system bag contains all necessary items for a safe and precise blood glucose measurement. It is light weight and can fit in a pocket or small handbag.

#### 1. Vitrex Compact Eject:

Lancing device with push button ejection. Suitable for use with Vitrex Soft Blood Glucose Lancets and most other popular lancet brands.

#### 2. Vitrex Soft Blood Glucose Lancets:

Universal soft lancet, compatible with most lancing devices.

#### 3. Blood Glucose Test Strips:

For fast blood measurement.

#### 4. Blood Glucose Monitor:

Easy-to-Use monitor with its two step operation, pre-set code, 5 sec. response time and memory of 500 tests with date and time.



1.

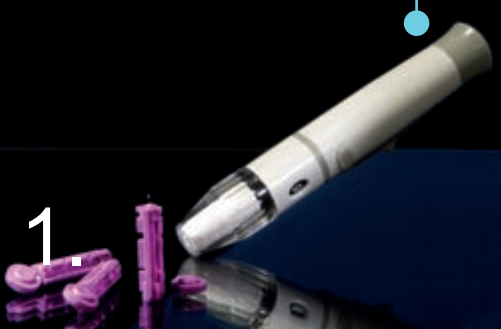

2.

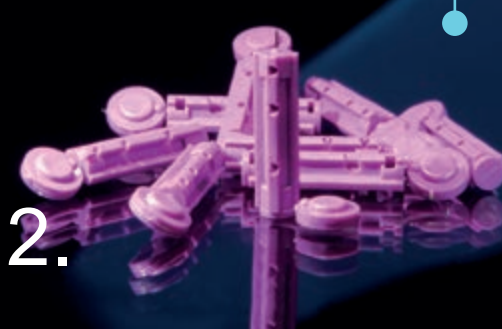

3.

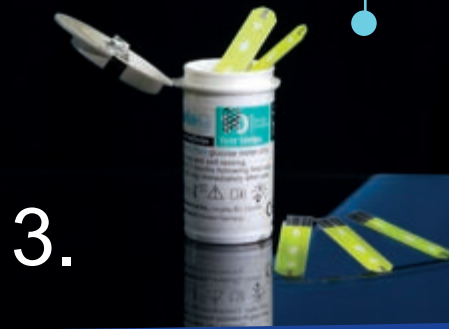



## Chirana® Insulin and Tuberculin Syringes

Chirana Insulin and Tuberculin syringes are integrated with a needle cap for single use. The needle cap is made of LATEX-FREE rubber gasket. The syringes are individually packed in boxes of 100 pcs. They are pyrogen-free and nontoxic.

**USER CONVENIENCE:** Needle permanently fixed to syringe body.

**USER SAFETY:** Integrated needle cap.

**COMFORT:** Grinded, precision lancet point and silicone treated tip for smooth penetration.

**PATIENT SAFETY:** Single-use only. Sterilised by ETO. No dead space volume.

### Technical Specifications

Type	Vol. ml.	Needle	Size Metric	Article No:
Tuberculin	1	29G x 1/2"	12.7 mm	CHTUB0129
Tuberculin	1	Luer		CHTUB01
Insulin U 40	1	29G x 1/2"	12.7 mm	CHINS4129
Insulin U 100	1	27G x 1/2"	12.7 mm	CHINS0127
Insulin U 100	1	29G x 5/16"	8 mm	CHINS01298
Insulin U 100	1	29G x 1/2"	12.7 mm	CHINS0129
Insulin U 100	1	30G x 1/2"	12.7 mm	CHINS0130
Insulin U 100	1	30G x 5/16"	8 mm	CHINS01308
Insulin U 100	1	31G x 4/16"	6 mm	CHINS01316
Insulin U 100	1	31G x 5/16"	8 mm	CHINS01318
Insulin U 100	1	Luer		CHINS01
Insulin U 100	0.5	29G x 1/2"	12.7 mm	CHINS00529
Insulin U 100	0.5	30G x 1/2"	12.7 mm	CHINS00530
Insulin U 100	0.5	30G x 5/16"	8 mm	CHINS005308
Insulin U 100	0.5	31G x 5/16"	8 mm	CHINS005318
Insulin U 100	0.5	31G x 4/16"	6 mm	CHINS005316
Insulin U 100	0.3	29G x 1/2"	12.7 mm	CHINS00329
Insulin U 100	0.3	30G x 1/2"	12.7 mm	CHINS00330
Insulin U 100	0.3	31G x 5/16"	8 mm	CHINS003318
Insulin U 100	0.3	31G x 4/16"	6 mm	CHINS003316



**Packaging:**  
 Primary packaging: 100 pcs.  
 Secondary packaging: 2,000 pcs.  
 Pallet: 30,000 pcs.

CHIRANA Syringes are available in many sizes.  
 Ask your diabetes educator or pharmacist for advice.

**Shelf life 5 years**



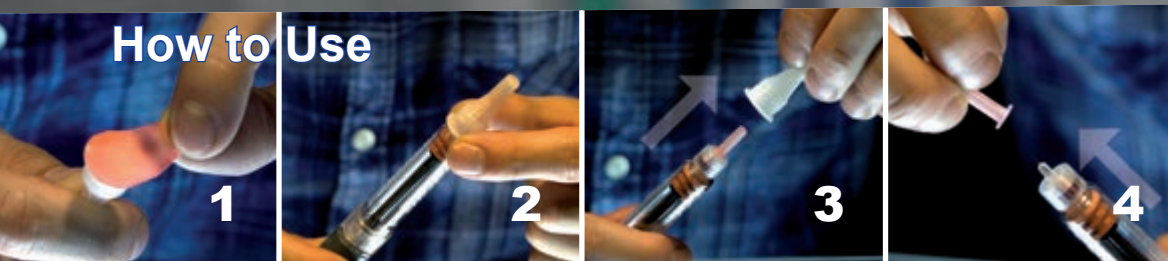

**1**  
Pull the paper tab off the pen needle.

**2**  
Screw needle onto the end of the insulin pen.

**3**  
Remove outer needle cover.

**4**  
Remove inner needle cover to expose the needle.

Your pen is now ready for use.

## Medoject Fine® Pen Needles

Medoject Fine Pen Needles are made of polypropylene hub and stainless steel tube. They are intended for Insulin application via most type A Insulin pens. The needles are sterile and individually packed.

### COMFORTABLE INJECTION

European, premium needle quality, triple beveled tip and precision lancet point grinding.

### THIN WALL TECHNOLOGY

Ensures optimal insulin flow.

### SILICONIZED NEEDLE

Minimizes irritation and gives a smooth penetration.

### SHORT NEEDLES

Reduce risk of a painful injection into the muscle.

### VERSATILE

Fit most commonly used insulin pens.

### COLOUR-CODING

Simple identification of different needle lengths.

## Technical Specifications

Colour Code	Specification	Article No.
Yellow	29G x 10 mm	CHPN2910
Pink	29G x 12.7 mm	CHPN29127
Dark blue	30G x 6 mm	CHPN3006
Light blue	30G x 8 mm	CHPN3008
Green	31G x 4 mm	CHPN3104
Dark violet	31G x 5 mm	CHPN3105
Dark blue	31G x 6 mm	CHPN3106
Light blue	31G x 8 mm	CHPN3108
Green	32G x 4 mm	CHPN3204
Dark violet	32G x 5 mm	CHPN3205
Dark blue	32G x 6 mm	CHPN3206

MEDOJECT Fine Pen Needles are available in many sizes. Ask your diabetes educator or pharmacist for advice.

**Shelf life 5 years**



Transit packaging

Pallet

**Packaging:**  
Primary packaging: 100 pcs.  
Transit packaging: 2,000 pcs.  
Pallet: 160,000 pcs.



5

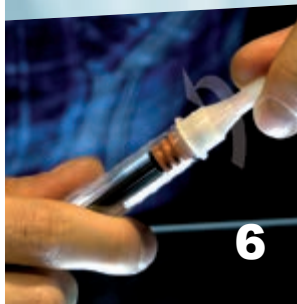

6

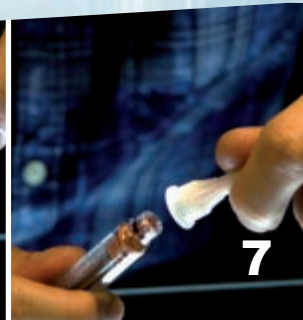

7

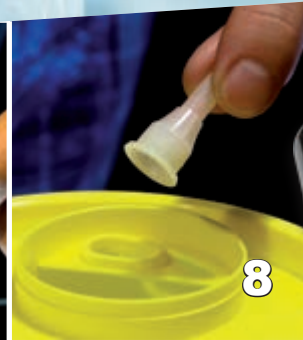

8



MySharps  
- new container for used  
insulin pen needles.

Place the outer needle cover  
over the needle.

Twist off the needle from  
the insulin pen.

Discard the used pen needle  
into a sharps container.

## Vitrex® Pen Needles

### COMFORTABLE INJECTION

Premium needle quality and triple beveled tip.

### THIN WALL TECHNOLOGY

Ensures optimal insulin flow.

### SILICONIZED NEEDLE

Minimizes irritation and reduces penetration forces.







### VERSATILE

Fit most commonly used insulin pens.

### COLOUR-CODING

Simple identification of different needle sizes.

### Technical Specifications

Colour Code		Specification	Article No.
Rose		29G x 12 mm	530313
Dark Blue		30G x 6 mm	530413
Turquoise		30G x 8 mm	530113
Grey		31G x 5 mm	530713
Orange		31G x 6 mm	530513
Green		31G x 8 mm	530613
Peach		32G x 4 mm	530213

Vitrex Pen Needles are available in many sizes.  
Ask your diabetes educator or pharmacist for advice.

**Shelf life 5 years**



Transit packaging

Pallet

**Packaging:**  
Primary packaging: 100 pcs.  
Transit packaging: 2,000 pcs.  
Pallet: 128,000 pcs.





### **CHIRANA T. Injecta**

CHIRANA T. Injecta, a.s.  
Slovakia

Nám. Dr. Alberta Schweitzera 194  
916 01 Stará Turá

Phone: +421 32 32 7709 901

e-mail: [sales@t-injecta.sk](mailto:sales@t-injecta.sk)



### **VITREX**

VITREX Medical A/S  
Denmark

Vasekaer 6-8  
DK 2730 Herlev

Phone: +45 4494 7011

e-mail: [vitrex@vitrex.dk](mailto:vitrex@vitrex.dk)



### **CHIRANA T. Injecta**

CHIRANA T. Injecta, s.r.o.  
Czech Republic

Komořanská 955  
143 10 Praha 4 – Modřany

Phone: + 420 241 768 407- 8

e-mail: [chirmax@chirmax.cz](mailto:chirmax@chirmax.cz)

